

# Digital Binoculars Camera

8X22 BINOCULAR & DIGITAL CAMERA

USER'S GUIDE

EASY TO OPERATE, USED AT ANYTIME OF YOUR  
CONVENIENCE, SUPER-CAPABILITY

# **Table of Contents**

1. Package Contents . . . . .	<b>01</b>
2. Features . . . . .	<b>02</b>
3. How to use Binocular . . . . .	<b>04</b>
4. Getting to know the Binocular and PC Camera . . . . .	<b>05</b>
5. Driver Installation . . . . .	<b>06</b>
6. Check the Driver Installation . . . . .	<b>06</b>
7. Function Menu Introduction . . . . .	<b>07</b>
8. Download Pictures . . . . .	<b>12</b>
9. Maintenance . . . . .	<b>13</b>
10. Warranty sheet . . . . .	<b>14</b>

## **Package Contents**

- Dual mode PC Camera. USB Connect Cable.
- CD-ROM for
  1. Driver for Windows 98SE / ME / 2000 / XP.  
(Windows 98 user could go to Microsoft's website [www.Microsoft.com](http://www.Microsoft.com) to upgrade to Windows 98SE)
  2. Arcsoft Photo Impression 4.0 / Arcsoft Photo Base 3.0.
- User's Guide.

## **System Requirements :**

- ◎ A computer equipped with the following(Recommend)
  - Operation System : Windows 98SE/ME/2000/XP
  - P 200MHz(or equivalent) processor or faster
  - 128 MB of RAM or more
  - 5MB available hard disk space(for install Driver)
  - 240MB available hard disk space(for install bundle software)
  - An available USB Port
- ◎ A high color (16 bit) or true color (24 bit) display card .
- ◎ A CD-ROM drive for installing of the driver and the bundled software(optional).
- ◎ An internet connection to get on internet for video conference and video mail.

© Sound card, speaker, earphone and microphone for video recording with audio.

IF you have any questions regarding your system specifications please call your PC manufacturer.

### **Features:**

3 in 1 (Digital Camera/PC Camera/Digital Camcorder)

- 8 X 22 Roof Prism Binocular
- Low Power Consumption
- Auto Shut Off
- Built-in 16MB Flash memory
- 90 seconds of Video
- Image Resolution-640x480 (VGA-Hi) 320x240 (QVGA-Lo)

## Preliminary Specifications:

<b>Camera :</b>	
Image sensor	CMOS VGA 640X480 pixels
Lens Specification	F4.0
O/S	Microsoft Windows 98SE / ME / 2000 / XP
White Balance	Auto
Exposure Control	Auto
Frame Rate - Video Mode	VGA 640 x 480 pixels 12-15 fps QVGA 320 x 240 pixels 20-30 fps
Movie Mode	QVGA 320 x 240 pixels up to 60 sec.@5fps
Display	Status LCD
PC Interface	USB 1.1
Storage	Internal:16 MB Flash Memory VGA: 53 images (Raw Data); 159 images (3 times compression) QVGA: 212 image(Raw Data); 636 images (3 times compression)
Power	AAA1.5 X2 (optional)
Bundled Software	ArcSoft Photo Impression 4.0, Photo Base 3.0
<b>Binocular :</b>	FULLY COATED OPTICS
Magnification	8 X 22
Angular field of view	7.0° Field of view at 1000YDS 122m
Exit pupil	2.8mm
Close Focusing Distance	5m APPROXIMATELY 15 FEET

Specifications are subject to change without prior notice.

## **How to use Binocular:**

### © ***IPD ADJUSTMENT***

Set IPD (Inter Pupillary Distance) by grasping the body and bending it until you can see one circle of view

The setting for your eyes will be indicated on the IPD Scale (Note the scale setting for later use.)

### © ***FOCUSING***

● Close your right eye and sight an object with your left eye. Focus the binocular by rotating the center focus wheel until the image is sharp and clear.

● Open your right eye and close your left eye. Rotate the right eyepiece until the object sighted is sharp and clear. (Note the setting of the diopter scale for later use.)

● Both sides (eyes) are now in focus and you will need to use only the center focus wheel to focus on the other objects.

### © ***RUBBER FOLD-DOWN EYE CUPS***

Fold down for use with eyeglasses and fold up for use without eyeglasses. They provide comfort and promote viewing ease.

## Getting to Know the Binocular PC Camera

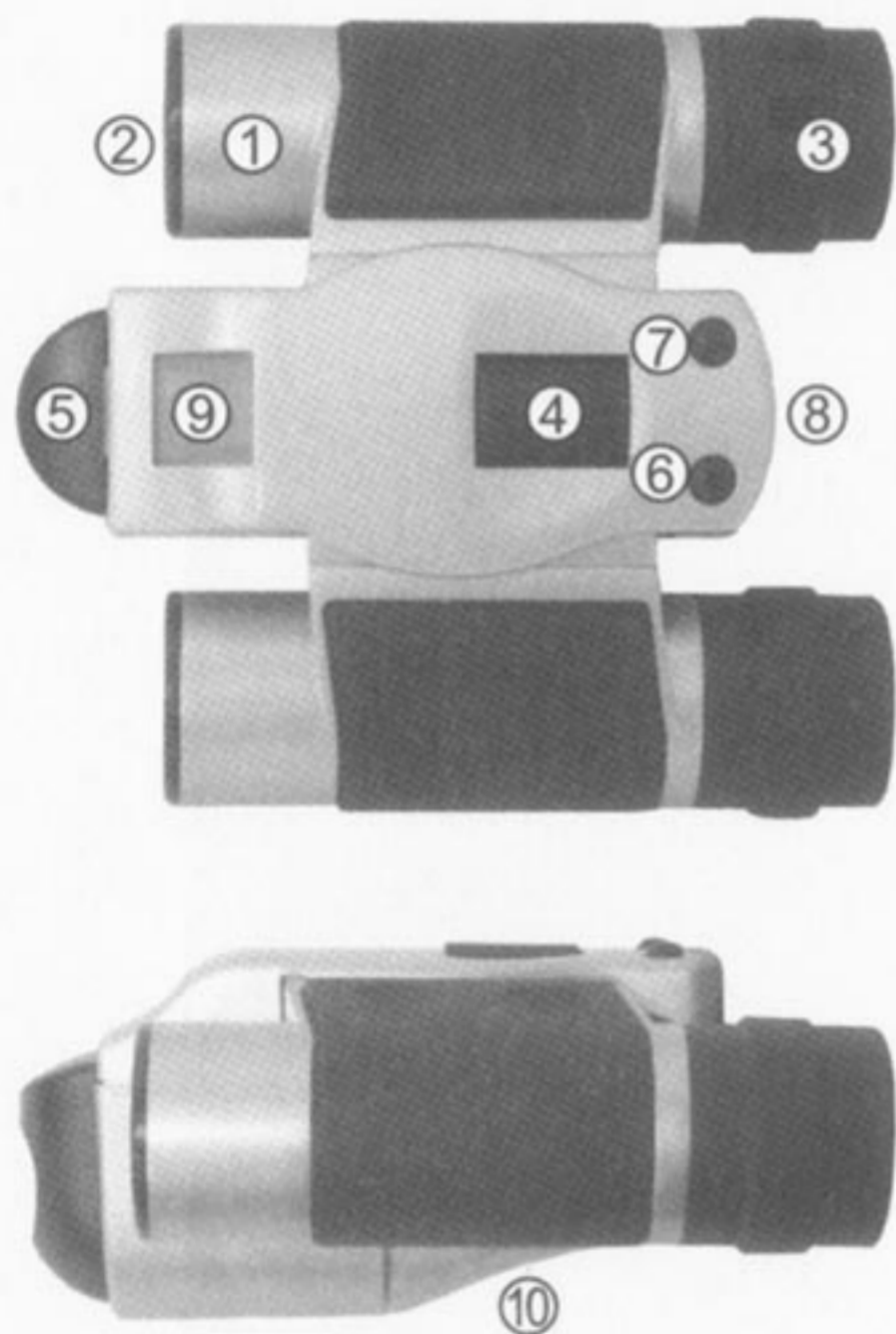

- ① Cone
- ② Objective Lens
- ③ Rubber Eyecup
- ④ Focusing wheel
- ⑤ Camera lens
- ⑥ On / Mode Button
- ⑦ Shutter / Set Button
- ⑧ USB port
- ⑨ LCD screen
- ⑩ Battery box

## **Driver Installation:**

You have two options to install the driver.

Make sure the Camera unplugged.and

(1)Put the Driver CD into the CD-ROM, it will pop up a Auto-Run Menu, you can follow the screen to install the driver.

(2)Put the Driver CD into the CD-ROM, Select "Start" → "Run" → X:\driver\setup.exe (X is the drive of your CD-ROM) See below Press OK to proceed driver installation or uninstall.

Now choose to install for the first installation.

Restart the system to complete installation.

After restarting the system, plug the connecting cable into the USB port. The hardware install wizard will appear. Wait for a minute, system will install the driver automatically.

## **Check the Driver installation:**

My Computer → Control Panel → System → Device Manager  
→ Imaging Device → " **MR97310 VGA Dual Mode Camera**"







- CL: To clear the last image you have taken. Press button 6 until "CL" appears. Press button 7 once and the LCD will flash. Press 7 again to erase the last image.



- CA: To clear all images. Press button 6 until "CA" appears. Press button 7 once and the LCD will flash. Press button 7 again and all the images will be erased.

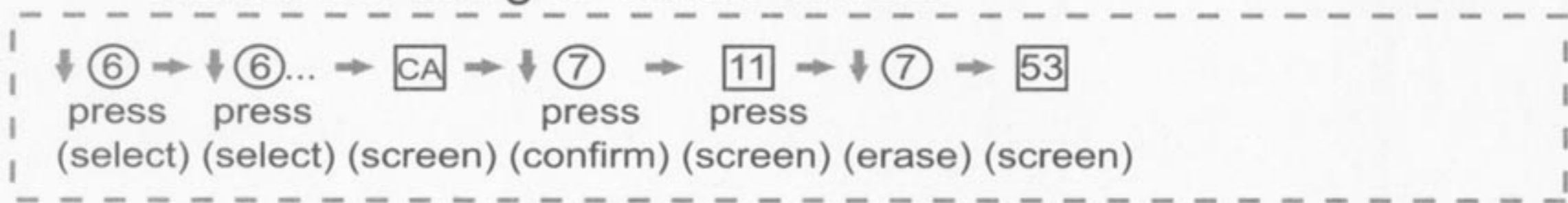

FUNCTION MENU ADDENDUM

Please note: After a Video recording "DC" will replace "CL" to clear the last video taken.



● CP: To set Compression (Low Resolution )

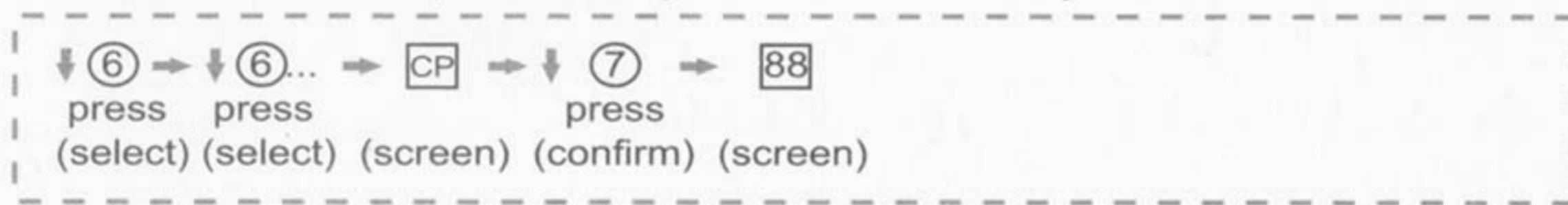

● F5:50Hz.

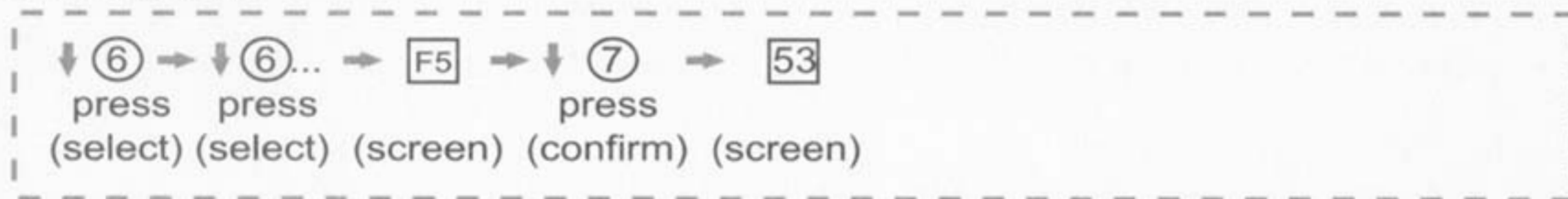

● F6:60Hz

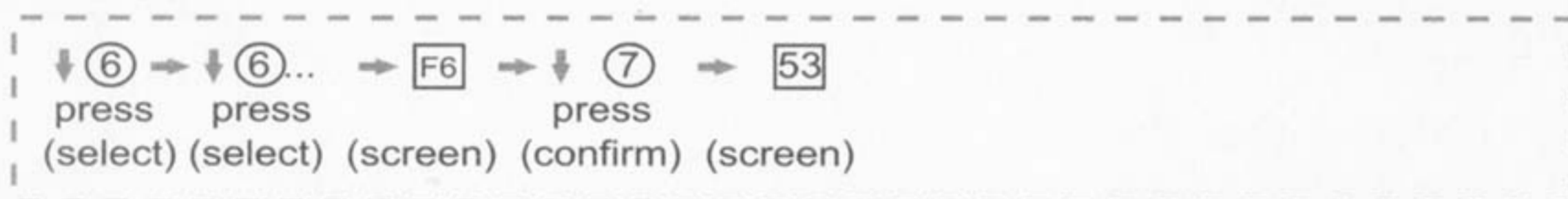

Note: 50Hz frequency is European standard, and 60Hz is American standard. When used indoor in Taiwan, florescent lights and appliances are American standard. thus set the digital camera in 60Hz mode to shoot the pictures. There is no restriction when shooting outdoor.

[Caution: Please make sure to confirm the status after you selected (button 7 Shutter / Set Button ⑦), otherwise the function will be stayed at last step.]

## **Download Pictures:**

**"Start" → "Programs" → "Webcam Mars 97310" →  
"Shortcut\_MrCAP\_TITLE" → "Option" → "Download pictures".**

## **Save AVI file:**

When you finished the download pictures procedure, click the AVI file. Select **"File" → "Save Active Item" or "Save all Items"**

When you finished the download pictures procedure, click the AVI file (At picture right-hand underside have move icon) can run AVI file format.

## **PC Camera mode:**

**"Start" → "Programs" → "Webcam Mars 97310" →  
"Shortcut\_MrCAP\_TITLE"  
"Mode" → "PC-Camera Mode"  
"Option" → "Preview"**

## **How to Install software:**

Simply put the provided software CD into your CD drive. The setup software will automatically start, prompting you through the steps to install the video and photo software. You may enter the selection for the destination folder, the Start menu, Programs group and other setup options.

Note if the Windows auto-run feature has been turned off on your computer, you will need to start the **Setup.exe** application on the software CD.

## **Maintenance**

Operating Environment 41 to 104 deg F (5 to 40 deg C) 20-85% relative humidity.

Special take care.

- Never immerse Digital Camera Binoculars or into any fluid or liquid.
- Remove dust or stains with a soft cloth dampened with water or neutral detergent.
- Keep the Digital Camera Binoculars in dry and cool dust-free environment or container when not in use.
- Please keep the Digital Camera Binoculars away from heat.
- Take the batteries out of the Digital Camera Binoculars, when they are not to be used for a long period of time.
- Avoid dropping the Digital Camera Binoculars.
- Do not disassemble the Digital Camera Binocular.

### Galileo Limited One Year Warranty

We guarantee to replace or, at our option, repair any products or parts thereof which are found defective in material or workmanship during the first year from date of purchase. Our obligation with respect to such products or parts shall be limited to replacement or repair, F.O.B. Miami, and in no event shall we be liable for consequential or special damages or for transportation, installation, adjustment, or other expenses which may arise in connection with such products or parts. A \$10.00 fee to cover postage and handling is required with the return of the product. No expenses, warranties and implied warranties, whether or not merchantability of fitness for any particular use or otherwise (except as to title) other than these expressly set forth above which are made in writing and signed by executive officer of our corporation.

NO LIABILITY FOR CONSEQUENTIAL DAMAGES, IN NO EVENT SHALL THE MANUFACTURER OR ITS SUPPLIERS BE LIABLE FOR ANY DAMAGES WHATSOEVER. BECAUSE SOME STATES DO NOT ALLOW THE EXCLUSION OR LIMITATION OF THE POSSIBILITY FOR CONSEQUENTIAL OR INCIDENTAL DAMAGES, THE ABOVE LIMITATION MAY NOT APPLY TO YOU.

GALILEO OPTICS  
DIVISION OF DISCIPLINE MARKETING INC.  
13872 SW 119th Ave • Miami, FL 33186